

Note:

Removal for defective transmission for longitudinal seat adjustment,

refer to 52 14 899

Move front seat as far forwards/upwards as possible.

**Important!**

Note safety regulations on handling airbag modules and pyrotechnical seatbelt tensioners,

refer to HG-72

Improper handling can lead to triggering of the pyrotechnical seat belt tensioner or side airbag, resulting in injuries.

Switch off ignition.

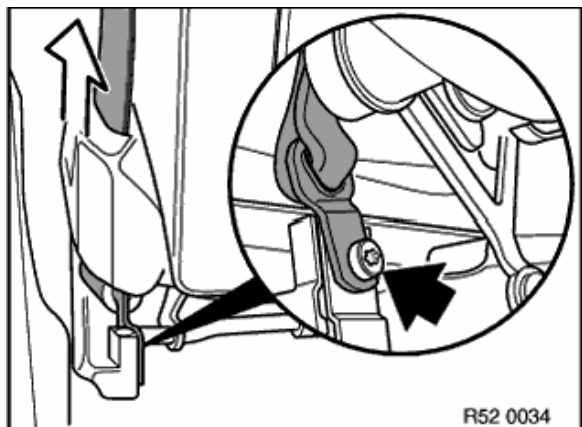

Unfasten seatbelt screw.

Tightening torque, refer to Technical Data 72 11 1AZ

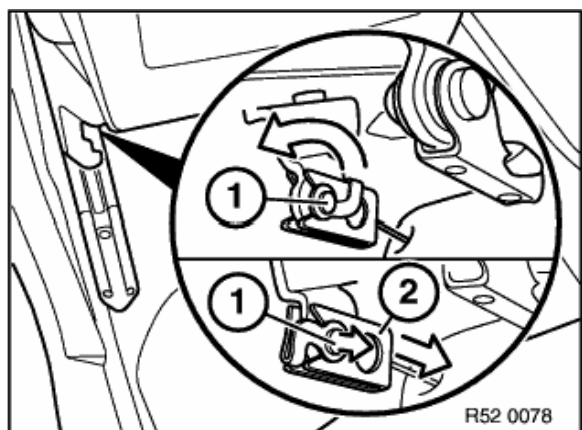

Pull retainer (1) backwards to unlock and pull inwards to remove. Lift Bowden cable (2) for seatbelt height adjustment forwards to remove.

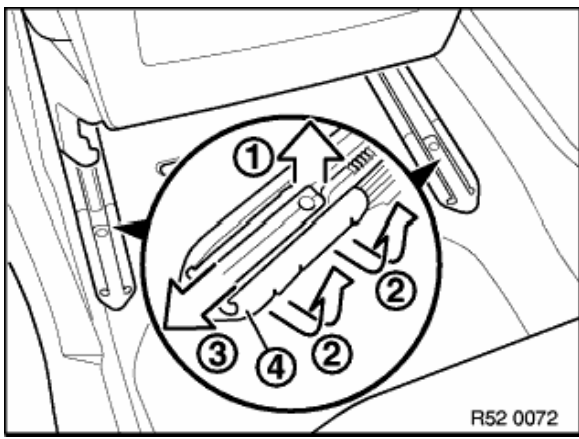

Important!

Failure to comply with this disassembly sequence causes the web (4) to break, thereby destroying the finisher.

Move front seat into furthest forward position.

- (1) Raise centre finisher slightly on detent head,
- (2) Unlock and lift out inner clip tabs,
- (3) Pull finisher backwards to remove.

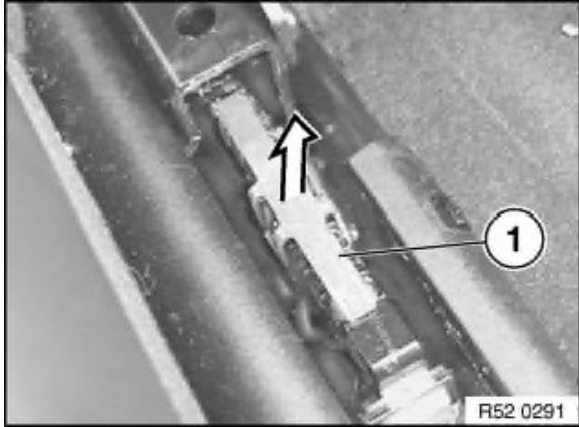

Only US driver's side:

Pull off detent (1) for longitudinal seat adjustment.

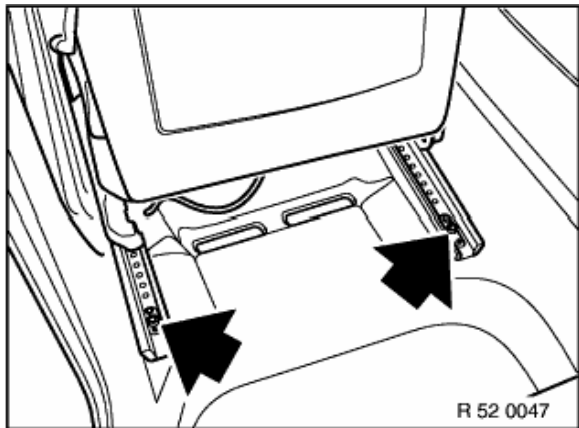

Unfasten screws.

Tightening torque, refer to Technical Data 52 10 1AZ

Move front seat as far back as possible.

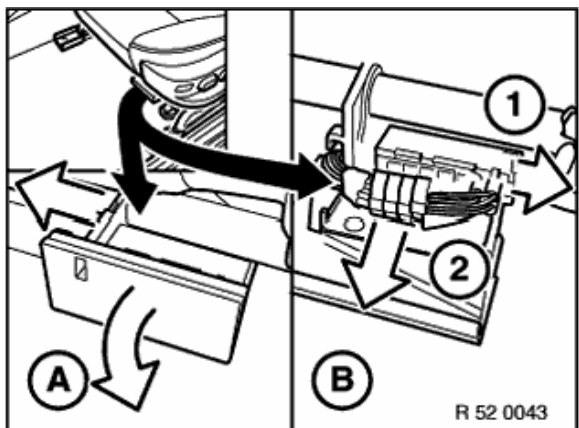

(A) Unlock cover and fold forwards.

(B) Disconnect connector (1) and remove (2).

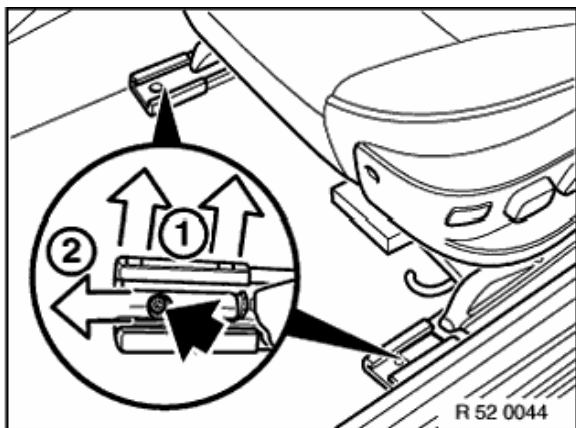

Up to 1996 model:
 Unfasten screw.
 Tightening torque, refer to Technical Data 52 10 5AZ
 Unclip inner finisher (1) and pull forwards (2) to remove.

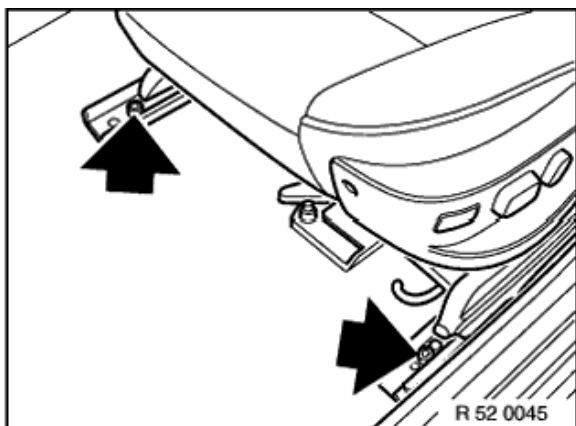

Up to 1996 model:
 Unfasten screws and lift out front seat.

Note:
 If the screws are not accessible, dismantle seat rail finishers inside,
 refer to 52 17 010

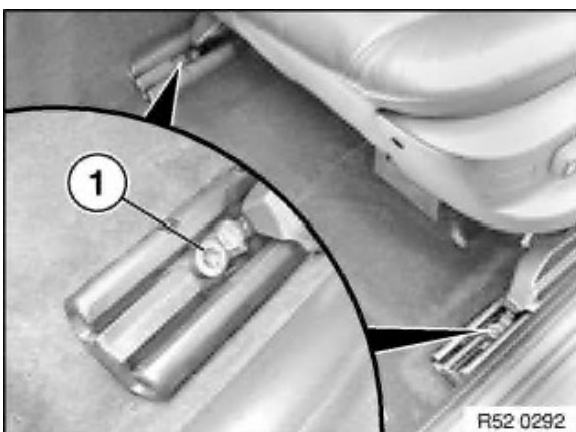

As of model year 1996:
 Unfasten screws (1) and lift out front seat.

Note:
 If the screws are not accessible, dismantle seat rail finishers inside,
 refer to 52 17 010



Installation:
 Floor carpet must not enter area between seat rails and floor panel beside screw points (grating noises).

Tightening sequence:
 Tightening torque, refer to Technical Data 52 10 1AZ
 Front inner, outer then rear inner, outer.